



SHARLOU

Length: 42.65 metres (139' 11")

Beam: 8.30 metres (27' 3")

Draft: 4.2 metres (13' 9")

Number of Guests: 8

Number of Crew: 6

Built: 2011

Refit: 2019

Builder: Vitters

Naval Architect: Tripp Design

Flag: British

Hull Construction: Carbon

Air conditioning, Gym/exercise equipment, WiFi connection on board

The 42.6m custom yacht SHARLOU was built in 2011 by Vitters. Her sophisticated exterior design and engineering are the work of Tripp Design, while her luxurious interior is designed by Rhoades Young. SHARLOU sleeps up to 8 guests in 5 staterooms, including 1 Master suite, 1 VIP Double stateroom, 2 convertible Double/Twin cabins (one also with Pullman) and 1 Single cabin. She can carry up to 6 crew onboard to ensure the best service for her Guests.

KEY FEATURES

- 1** Carbon hull to guarantee sailing performance in total comfort
- 2** October 2020 - Brand new inventory of black North Sails 3D technology
- 3** Full beam master cabin
- 4** Flexible cabin configuration
- 5** A section of the aft cockpit can be flooded, transforming it into a paddling pool for children
- 6** 52ft Windy SR52 chase boat with her dedicated Captain



Cockpit



Al fresco dining table



Chase tender



Sunbathing area



Sunbathing area



Detail



Swimming platform



Main salon



Navigation desk



Formal dining table



Galley



Double cabin



Double cabin



Main cabin



Twin cabin



Double cabin



Owner's ensuite



Owner's ensuite

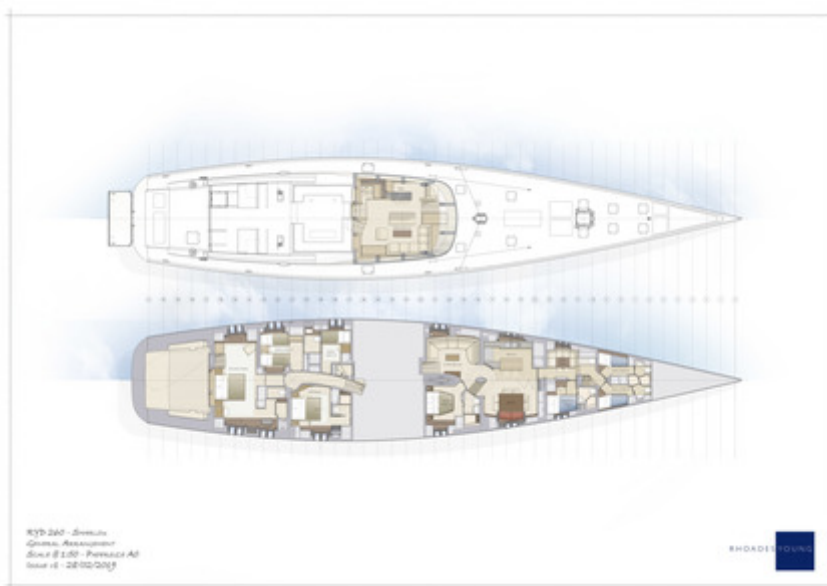

Layout



Zenith



Water toys



Wheels



Sunbathing area



Bow



Detail



Swimming platform



Water sports



Water sports



Inflatable sailing dinghy



Water sports



Main salon



TV area



Detail



Chase tender



SPECIFICATIONS

ACCOMMODATION

Number of Guests: 8

Number of Cabins: 5

Cabin Configuration: 1 Single, 2 Double, 1 Triple, 1 Convertible

Bed Configuration: 1 Pullman, 1 Queen, 1 Double, 5 Single

EQUIPMENT

Engines: Caterpillar C12 (one main engine) 366BKW

2 x Kilopak generators x 50kw

Fuel consumption with the engine plus one genset at cruising speed of 10 knots = 60 L/h

Range with the engine on = 2200

Range with the sails on = 10000

Max speed with the engine on = 13 knots

Max speed with the sails on = 17 to 20 knots

Cruising speed with the engine on / sails on = 11 knots

Cruising Speed: 11 knots

Fuel Consumption: 60 Litres/Hr

WATERSPORTS

Tenders + Toys: 2020: Full set of 3D Black sails

Windy SR 52 Blackbird CHASE BOAT(10 guests cruising, 1 cabin with ensuite bathroom, sunbed forward, 1bbq, 1 fridge & freezer, scuba gear. Cruising speed 30 knots, max speed 40 knots. Fuel consumption approx. 100L/h at 30 knots)

Zodiac MK4 Semi-custom 555 Tender with 1 x 70 HP engine

3 x Seabobs F5S

2 x Naish Paddle boards

Scuba diving equipment / 10 BCDs by Scuba Pro (RDV diving only)

2 x Wake board

1 x Wake skate

Water skis (adult & child sizes)

Kite surfer

2 x Sailing dinghies (inflatable)

Towables (Doughnut biscuit & Wow Sports wheel)

2 x Inflatable Kayaks

Fishing gear (including deep sea fishing)

Snorkeling gear (different sizes)

Splash Pool on Aft Deck

LAYOUT

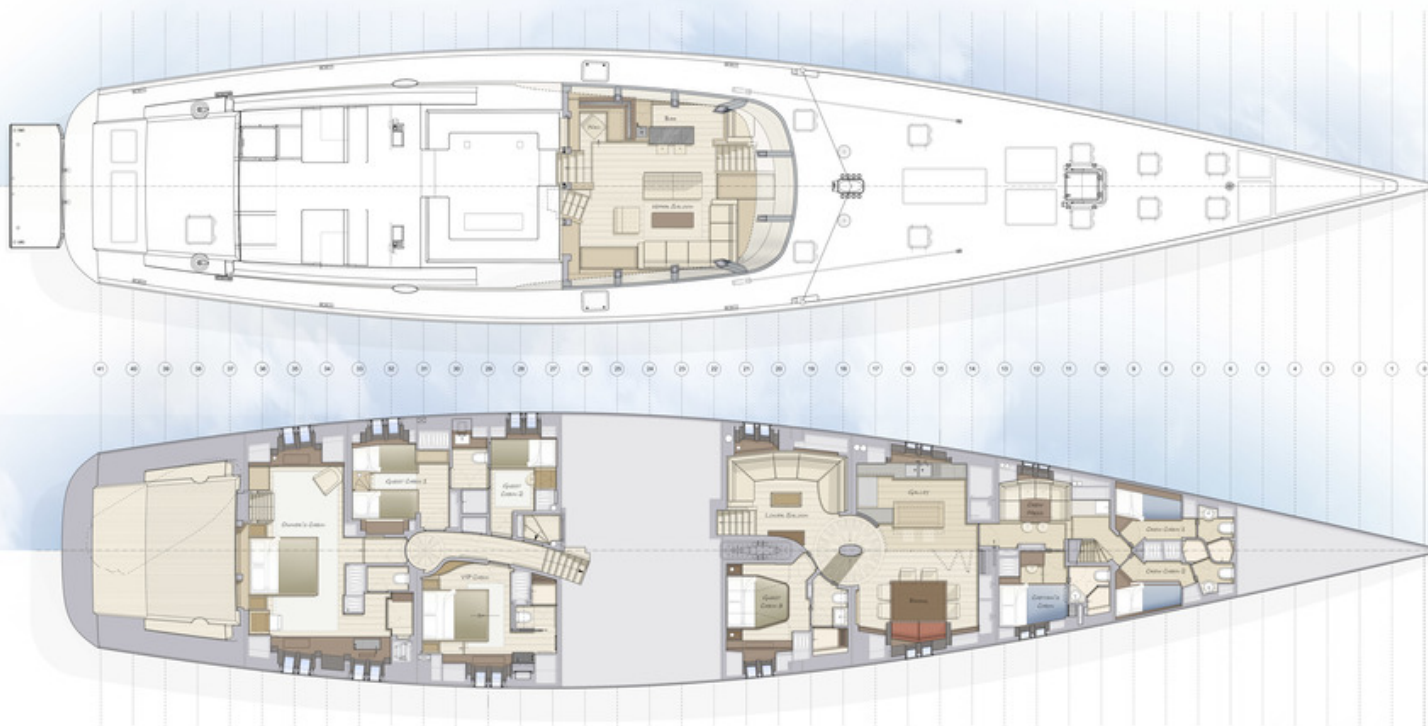

RYD 260 - SHARLOK
GENERAL ARRANGEMENT
SCALE @ 1:50 - PAPER SIZE A0
ISSUE V1 - 28/02/2019

RHOADES YOUNG

Disclaimer

This document is not contractual. All specifications are given in good faith and offered for informational purposes only. The publisher and company do not warrant or assume any legal liability or responsibility for the accuracy, completeness, or usefulness of any information and/or images displayed. Yacht inventory, specifications and charter prices are subject to change without prior notice. None of the text and/or images used in this brochure may be reproduced without written consent from the publisher.